

AS PROPOSED SECOND FLOOR PLAN
(Scale 1:50)

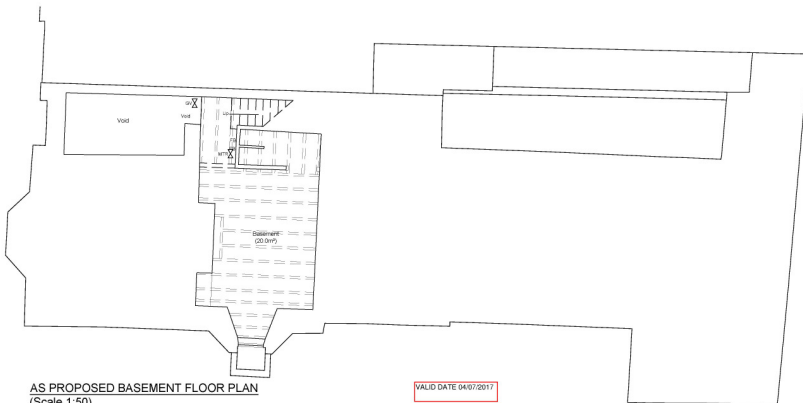

AS PROPOSED BASEMENT FLOOR PLAN
(Scale 1:50)

VALID DATE 04/07/2017

THIS COPY HAS BEEN MADE BY OR WITH THE AUTHORITY OF STEPHEN PROSPECT DESIGN PURSUANT TO SECTION 17 OF THE COPYRIGHT DESIGN AND PATENTS ACT 1988. UNLESS THAT ACT PROVIDES A RELEVANT EXCEPTION TO COPYRIGHT, THIS COPY MAY NOT BE COPIED WITHOUT THE PRIOR PERMISSION OF THE COPYRIGHT OWNER.

© Prospect Design Architectural Services

Notes
Do not scale from this drawing or consider any dimension to be accurate.
In the event of any discrepancy being found, these should be brought to the attention of the Prospect Design for further instruction.
This drawing is for Planning purposes only and is not to be considered a consultation or setting out drawing.
North Point shown approximately.
The proposed layouts are subject to the following, although not exhaustive:
1. Structural Engineers Requirements.
2. Mechanical and Electrical Engineers Requirements.
3. Drainage Requirements.
4. Planning Approvals.
5. Building Regulations approval.

REV	AMENDMENT	DATE

CONTRACTOR MUST VERIFY ALL DIMENSIONS ON SITE BEFORE COMMENCING ANY WORK OR MAKING ANY SHOP DRAWINGS

PROSPECT DESIGN
Architectural Services
54 Hennings, Malton, N. Yorks, YO17 7JF
Tel: 01953 692372 Mob: 07792700035
Email: info@prospectdesign.co.uk web: www.prospectdesign.co.uk

Client:
MR & MRS HANAGAN
18 THE MOUNT
MALTON
YO17 7ND

Job Title:
ALTERATIONS TO 18 THE MOUNT,
MALTON

Drawing Title:
AS EXISTING BASEMENT
AND SECOND FLOOR PLANS

Scale:	1:50 @ A1	Drawn:	R.W.
Date:	13.06.2017	Checked:	...

Drawing Number: PD230-02